

G. GIOANOLA



SUPER DRY

360° ROTATING COUNTER
FOR EASY READING
DRY DIAL

MID

2004/22/CE



MODELS
USF/15 – USC/15
USF/20 – USC/20

- ❖ Single jet **Super Dry** dial, turbine water meter with rotating counter through 360°
- ❖ Straight reading on 5-digit roller counter
- ❖ For turbid, calcareous water with suspended sediments: a completely **dry** and unsubmerged register. The impeller is the only part in contact with water.
- ❖ **Protective cover** and glass wiper available as options
- ❖ USF model for cold water, measuring range R80, temperature classes 30°C and 50°C
- ❖ USC model for hot water, measuring range R80, temperature classes 70°C and 90°C
- ❖ USF-SA FROST PROTECTION model for cold water, measuring range R80, temperature classes 30°C and 50°C equipped with water volume increase compensation system when frosting
- ❖ **U0-D0**: straight pipe not required upstream or downstream the meter
- ❖ May be installed in any position
- ❖ All models are **MID** approved according to the European Directive **2004/22/EC** (module B+D) and in compliance with the norms **EN 14154** and **OIML R49**
- ❖ All models can be supplied fitted with a pulse-emitting device or pre-equipped to retrofit a pulse-emitting device, on request

SUPER DRY

| Nominal size of the meter | | | 15 - 1/2* | 20 - 3/4 | | | | |
|---------------------------|---|------|--------------------|------------------|--|--|--|--|
| Q ₃ | Permanent flow rate | m³/h | 2,5 | 4,0 | | | | |
| Q ₄ | Maximum flow rate for short period | m³/h | 3,125 | 5,0 | | | | |
| Q ₂ | Transitional flow rate with measuring range R80 [MPE ±2%] | l/h | 50 | 80 | | | | |
| Q ₁ | Minimum flow rate with measuring range R80 [MPE ±5%] | l/h | 31,25 | 50 | | | | |
| S | Accuracy at measuring range R80 | l/h | 7 | 15 | | | | |
| ΔP | Pressure loss class | bar | 0,63 | 0,63 | | | | |
| MAP | Maximum allowed working pressure | bar | 16 | 16 | | | | |
| | Dial register from/to | m³ | 0,0001 / 100.000 | 0,0001 / 100.000 | | | | |
| A | Lenght without couplings | mm | 110-80 115-170 | 130 | | | | |
| | Lenght with couplings | mm | 190-160 195-250 | 228 | | | | |
| B | Maximum diameter | mm | 72 | 72 | | | | |
| C | Height with open lid | mm | 138 | 143 | | | | |
| D | Height with closed lid | mm | 70 | 74 | | | | |
| E | Height of tube | mm | 16 | 19 | | | | |
| | Weight with couplings | kg | 0,660 | 0,840 | | | | |
| | Weight without couplings | kg | 0,500 | 0,600 | | | | |

* Special model with body lenght 115 mm 3/4" x 3/4" or 3/4" x 7/8" threaded available upon request

MODELS:

Temperature Class T30-T50

USF/15 R80
USF/20 R80

Temperature Class T70-T90

USC/15 R80
USC/20 R80

Temperature Class T30-T50

With system that compensates the water increase when frosting

USF-SA/15 R80
USF-SA/20 R80

Different "R" values available upon request

The Company's policy is one of continuous product improvement and the right is reserved to modify the specification contained herein without notice. 02-16

PULSED WATER METER



REED SWITCH PULSE EMITTER – TECHNICAL DATA

- Contact ratings: 24 V - 0,2 A
- Standard length of cable supplied: 2 m

PULSE VALUES K

- Number of litres per pulse available (pulse value must be stated when ordering): 0,25 – 0,5 – 1 – 2,5 – 5 – 10 – 25 – 50 – 100 – 250 – 500 – 1000

M-BUS OPTION

Mod. ADAPTO (to purchase separately): adapter to convert the signal generated by the reed sensor into a M-Bus signal

AVAILABLE OPTIONS ON REQUEST

- A non-return valve can be fitted upon request;
- All models can be customised with the serial number (also in bar code format) marked on the dial;
- Nickel-plated housing available upon request;
- Teflon-coated housing for demineralized water available upon request.

FROST PROTECTION SYSTEM

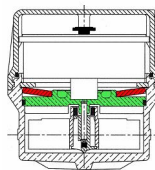

The water volume increase is absorbed by the Bauer Spring which will bring to normal conditions the pressure plate after de-frost, keeping unchanged the measuring accuracy characteristics.

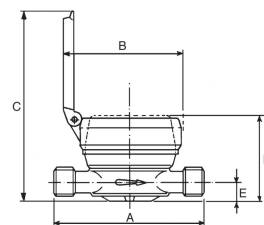

TYPICAL ERROR CURVE

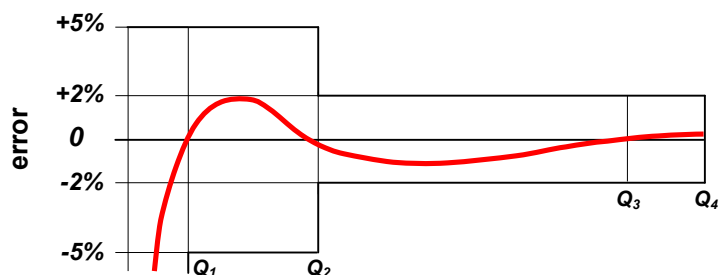

HEAD LOSS DIAGRAM

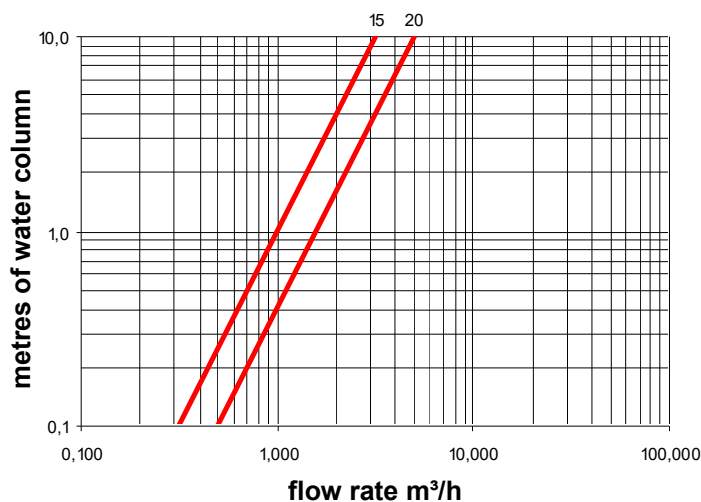

G. GIOANOLA SISMA meters

Str. Alessandria 50 - 14049 NIZZA MONF.TO (AT) ITALY - Tel. +39.0141.793536 - Fax +39.0141.702757 - E-mail: info@gioanola.it – <http://www.gioanola.it>